

Duke Energy Convention Center

exhibit hall: level 1 195,320 total square feet

The main exhibit hall encompasses nearly 200,000 square feet of contiguous exhibit space—enough to comfortably accommodate nearly 1,000 booths. The main floor is dividable into three separate halls.

exhibit level (first floor)

- 195,320 square feet of exhibit space
- Expansive 48,500-square-foot lobby
- 17 enclosed receiving docks with three low docks and 14 dock levelers
- Three drive-onto-floor entrances—one to each hall
- Two freight elevators with 20,000 lb. capacity (21' x 13'5"-17' x 14'5") and one freight elevator with 15,000 lb. capacity (19'6" x 11'8")
- Lighting—400-watt metal dimmable halide

- Utility connections—electric, telecommunications, air, water, gas and drainage
- Electric power—120, 208, 460 volt, single and three phase

Hall	Sq. Ft.	Ceiling Height	Exhibits (10'x10')	Meeting Capacity	Drive-Onto-Floor Door Sizes
Hall A	92,350	36'/20'	448	7,000	18'h/21'w
Hall B	60,190	36'/20'	292	3,800	18'h/20'w
Hall C	42,780	34'3"	213	4,200	20'h/24'w
Combined	195,320	36'/20'	990	14,000	

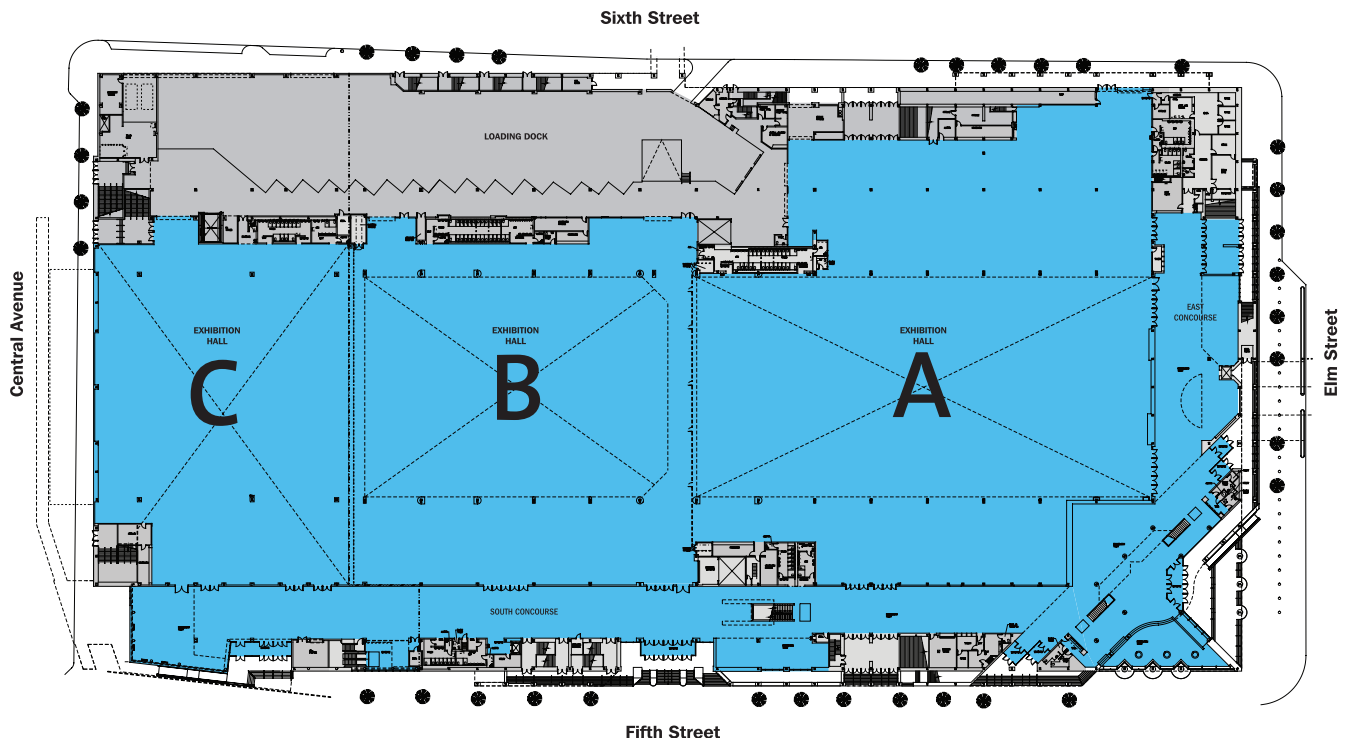

Duke Energy Convention Center

meeting rooms: level 2

31 total meeting rooms—45,440 square feet

The two upper levels of the Duke Energy Convention Center provide 37 deluxe meeting rooms with planning flexibility to accommodate groups of 24 to 4,100.

meeting level (second floor)

- 31 deluxe meeting rooms, fully carpeted
- Lighting — fluorescent lamps and dimmable incandescent flood lamps
- Individually controlled room temperature, sound and lighting
- Sound abatement wall treatment
- Optional exhibit overlook
- Three pedestrian connections to Cincinnati's Skywalk system, hotels and parking garages

WEST—ROOMS 250-264

Room No.	Dimensions	Sq. Ft.	Ceiling	Theatre	Banquet	Classroom
250	41x28	1,148	16'	120	60	58
251	40x24	960	16'	120	60	58
252	40x28	1,120	16'	120	60	58
260	36x22	775	14'	75	40	36
261	36x22	775	14'	75	40	36
262	36x47	1,692	14'	160	80	84
263	39x47	1,833	16'	180	120	96
264	40x47	1,880	16'	180	120	96
260-262	73x43	3,170	16'	340	160	168
263-264	79x45	3,550	16'	400	240	184

NORTH—ROOMS 200-213

Room No.	Dimensions	Sq. Ft.	Ceiling	Theatre	Banquet	Classroom
200	60x49	2,890	16'	320	210	160
201	39x49	1,872	16'	180	120	112
202	28x49	1,344	16'	140	80	66
203	28x47	1,320	16'	140	70	66
204	39x47	1,820	16'	180	120	112
205	56x47	2,610	16'	320	210	160
206	59x63	3,705	16'	420	220	210
207	38x31	1,178	16'	112	80	56
208	38x31	1,178	16'	112	80	56
200-208	60/96'x218'	17,917	16'	1,924	1,200	1,004
209	30x23	690	16'	60	40	24
210	30x23	690	16'	72	40	28
211	40x41	1,630	16'	162	120	80
212	40x42	1,722	16'	162	120	80
213	30x26	790	14'	78	50	28

SOUTH—ROOMS 230-238

Room No.	Dimensions	Sq. Ft.	Ceiling	Theatre	Banquet	Classroom
230	36x32	1,145	16'	98	80	53
231	36x31	1,085	16'	98	80	53
232	40x63	2,500	16'	252	140	128
233	33x63	2,100	16'	252	140	126
230-233	109x63	6,880	16'	780	500	384
234	26x33	850	16'	84	50	32
235	25x33	820	16'	84	50	32
236	51x30	1,500	16'	150	100	64
237	37x24	864	16'	100	60	36
238	37x23	850	16'	100	60	36

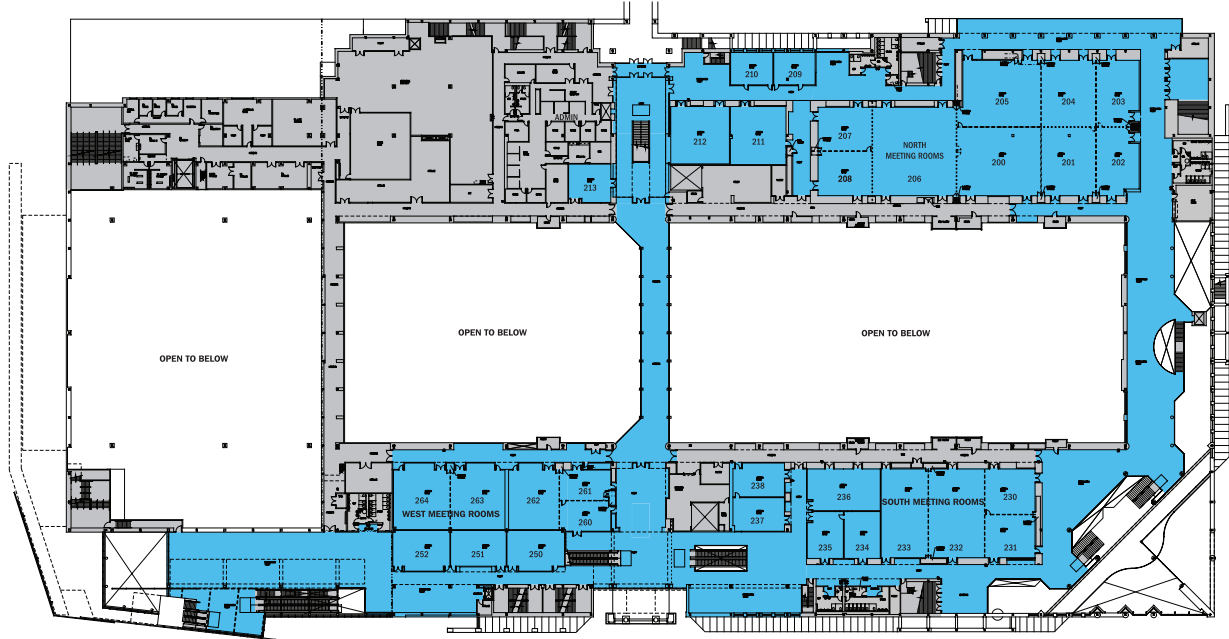

Duke Energy Convention Center

ballrooms: level 3

6 total meeting rooms—56,940 square feet

Duke Energy Convention Center’s nearly 40,000 square foot new Grand Ballroom is one of the largest in the Midwest and the largest in downtown Cincinnati.

ballroom level (third floor)

- 39,470 square foot Grand Ballroom
- 17,470 square foot Junior Ballroom
- 20,000 square feet of pre-function space
- VIP Suite/“Green Room”
- Lighting—metal halide lighting for exhibits and meetings; dimmable incandescent lighting for banquets
- Full-service banquet kitchen capable of serving up to 5,000 meals in a single sitting

BALLROOM LEVEL

Room No.	Dimensions	Sq. Ft.	Ceiling	Theatre	Banquet	Classroom
Grand	156x253	39,468	33'6"	4,100	2,500	2,100
A	156x106	16,536	33'6"	1,700	1,000	850
B	156x152	23,712	33'6"	2,300	1,500	1,200
Junior	156x112	17,472	19'9"	1,800	1,000	900
A	77x54	4,158	19'9"	430	250	218
B	77x58	4,466	19'9"	460	270	232
C	77x54	4,158	19'9"	430	250	218
D	77x58	4,466	19'9"	460	270	232

